

SOLDER SUFFIX	CUSTOMER TERMINAL	RoHS	LEAD(Pb)-FREE	8C
LF3	Sn100%	Yes	Yes	

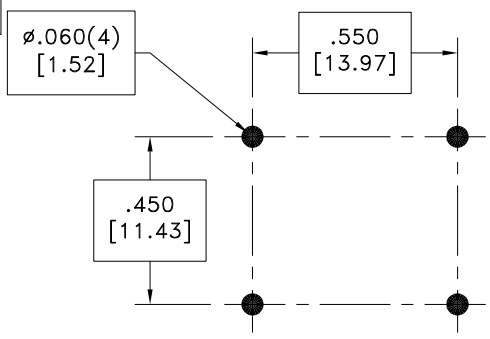
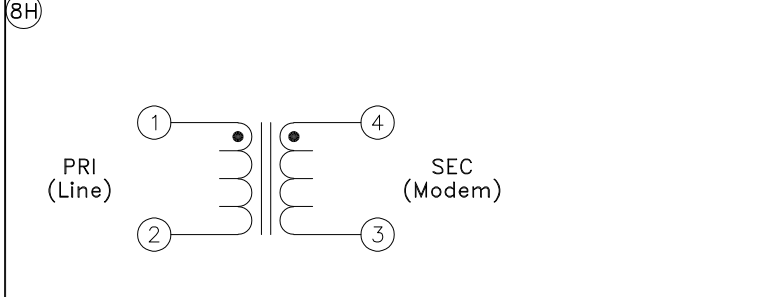

RECOMMENDED
P.C. PATTERN, COMPONENT SIDE

ELECTRICAL SPECIFICATIONS @ 25°C unless otherwise noted:

- IMPEDANCE:** 600 ohms each, PRI & SEC (ref). Designed to reflect 600 ohms on PRI with 470 ohm load on SEC.
- LONGITUDINAL BALANCE:** 66dB min., 60 - 1000Hz; 46dB min., 1000 - 4000Hz, per FCC Part 68.310, with terminal 3 or 4 grounded.
- D.C. RESISTANCE (@20°C):** PRI, 108 ohms ±10%. SEC, 120 ohms ±10%.
- FREQUENCY RESPONSE:** ±0.65dB, 600 to 3500Hz; ±2.5dB, 300 to 600Hz, ref. 1kHz.
- INSERTION LOSS:** 2.0 ±0.5dB at 1000Hz per IEEE method, 20°C.
- DIELECTRIC RATING:** 1000VAC, 1 minute tested by applying 1250VAC for 1 second between PRI-SEC; PRI-core. Meets or exceeds requirements of: CAN/CSA-C22.2 No.225 (M90); DOC's CS-03 (Issue 7); UL's UL1459, 2nd Ed. (1992); and FCC's Part 68 (58 FR 44907, Aug. 25, 1993).
- 7A 7E 7L**
- 7E** **TURN RATIO:** 1:1, ±2%.
- 7W** **OPERATING CONDITIONS:** All specs. except as noted to be from -30 to +4dBm, 0 to 100mADC in PRI, 600 ohm source resistance on PRI, 470 ohm load on SEC.

- 7E** **TOTAL HARMONIC DISTORTION:** -71.5dB typ. at 600Hz, -10dBm.
- 7W** * Marking Detail may be rotated 90° clockwise. Locating Dot will not move.
- Wurth Electronics Midcom Inc. p/n 671-8005-LF3 is eiSos p/n: 7500718005
- 8E** Wire insulation & RoHS status not affected by wire color. Wire insulation color may vary depending on availability.

AGENCY NUMBER	
UL	E205930

Unless otherwise specified:
Tolerances:
Angles: ±1°
Fractions: ±1/64
Decimals: ±.005[.13]

This drawing is dual dimensioned.
Dimensions in brackets are in millimeters.

DRAWING TITLE
TRANSFORMER
DC COUPLING
eiSos p/n: 7500718005

8D

SEE REVISION SHEET FOR REVISION LEVEL

Midcom **WE**
www.we-online.com/midcom

PART NO. **671-8005-LF3**

8H 8C REV. 8H 12/22

SPECIFICATION SHEET 1 OF 1

PART #
671-8005-LF3