

CUSTOMER TERMINAL	RoHS	LEAD(Pb)-FREE
Sn96%, Ag4%	Yes	Yes

PART MUST INSERT FULLY TO SURFACE A IN RECOMMENDED GRID
 #.031(7)
 [.80]

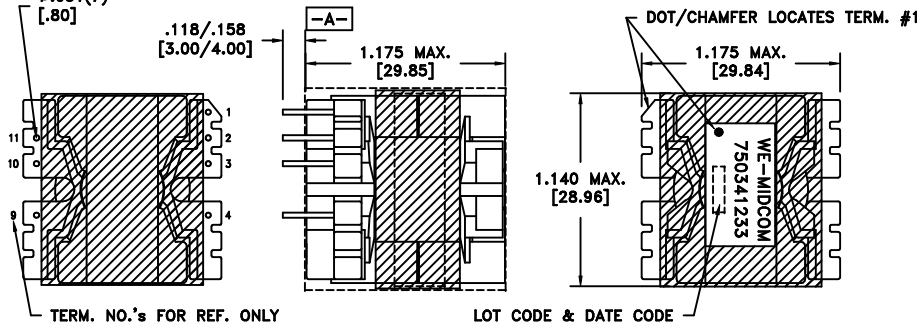

ELECTRICAL SPECIFICATIONS @ 25°C unless otherwise noted:

PARAMETER	TEST CONDITIONS	VALUE
D.C. RESISTANCE	4-1 @20°C	0.095 ohms max
D.C. RESISTANCE	10-9 @20°C	0.21 ohms max
INDUCTANCE	4-1 10kHz, 100mVAC, Ls	300uH ±10%
DIELECTRIC	4-10 625AC, 1 second	500VAC, 1 minute
DIELECTRIC	4-CORE tie(1+10), 625VAC, 1 second	500VAC, 1 minute
TURNS RATIO	(4-1):(10-9)	7.6:1, ±2%

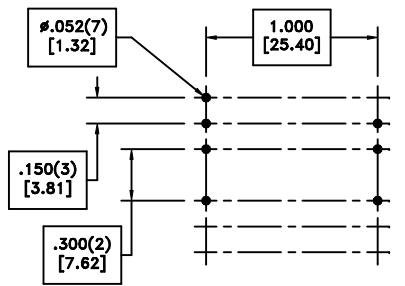
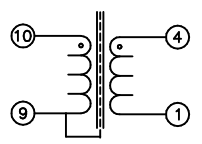

RECOMMENDED P.C. PATTERN, COMPONENT SIDE

Wire insulation & RoHS status not affected by wire color.
 Wire insulation color may vary depending on availability.

REV.	DATE
00	9/11

Packaging Specifications
 Method: Tray
 PKG-0807
www.we-online.com/midcom
 SEE REVISION SHEET FOR REVISION LEVEL

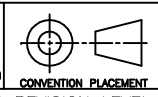

Tolerances unless otherwise specified:
 Angles: ±1° Decimals: ±.005 [.13]
 Fractions: ±1/64 Footprint: ±.001 [.03]
 This drawing is dual dimensioned. Dimensions in brackets are in millimeters.

DRAWING TITLE
PFC INDUCTOR
 eiSos p/n: 750341233

PART NO.
750341233
 SPECIFICATION SHEET 1 OF 1